

PLAN VIEW

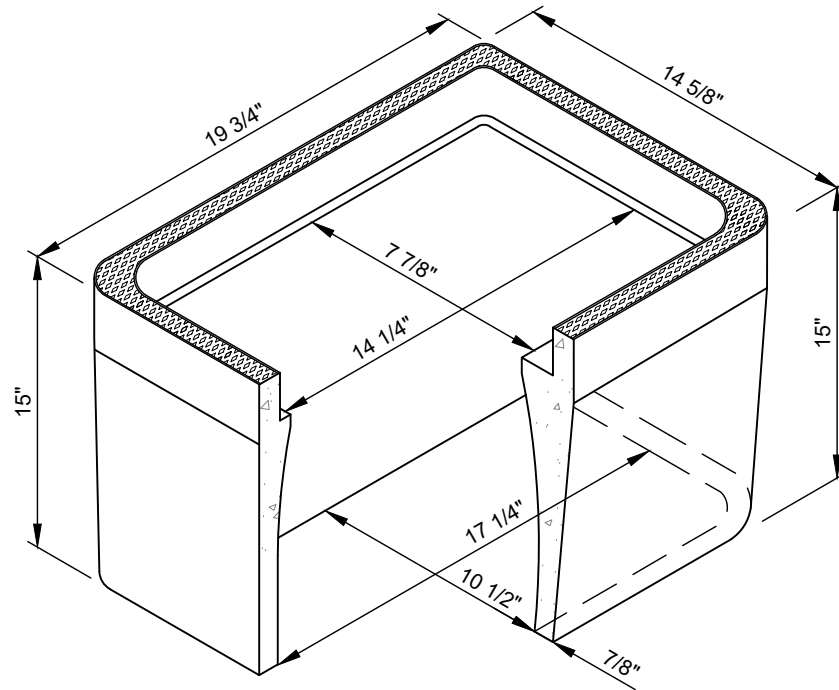

BODY

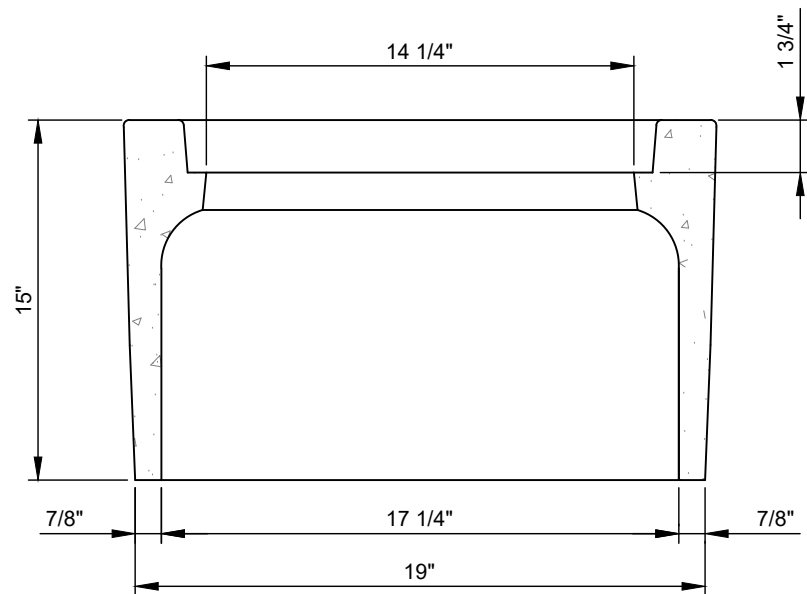

SECTION VIEW A - A

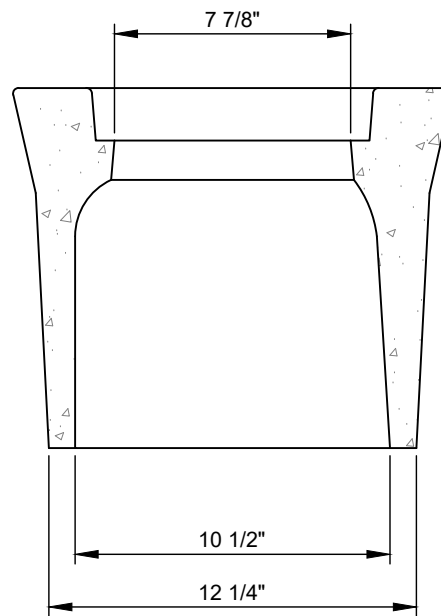

SECTION VIEW B - B

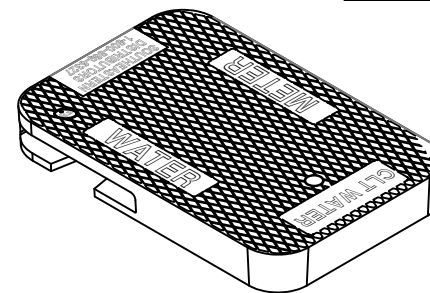

PLASTIC LID

NO. DESCRIPTION:

1. 1 3/8" RADIUS.
2. 5/8" RADIUS.
3. 3 3/8" RADIUS.

NOTES:

- A. METER BOX SHALL ACCOMMODATE COMPANION PLASTIC METER BOX LID - SEE STANDARD DETAIL.
- B. MINOR DIMENSION VARIATIONS ARE PERMITTED, BASED ON MANUFACTURER'S PRODUCT LINES, PROVIDED THE CLTW STANDARD PLASTIC LID FITS PROPERLY.
- C. CONCRETE SHALL BE MINIMUM $f_c = 4,000$ PSI COMPRESSIVE STRENGTH.
- D. DESIGN SHALL CONFORM TO ASTM C858-SPECIFICATIONS FOR "UNDERGROUND PRECAST CONCRETE UTILITY STRUCTURE".
- E. STEEL REINFORCING DESIGN SHALL CONFORM TO ASTM C857.
- F. WELDED WIRE FABRIC SHALL CONFORM TO ASTM A185 AND A82.
- G. WHEN METER HAS TO BE IN SIDEWALK, USE THIS DETAIL ONLY (CONCRETE BOX).

MANUFACTURERS:

SOUTHERN METER C.H. 5/8" x 3/4" METER BOX BODY

BOX BODY WEIGHT - 88 LB