

TYPICAL MANHOLE

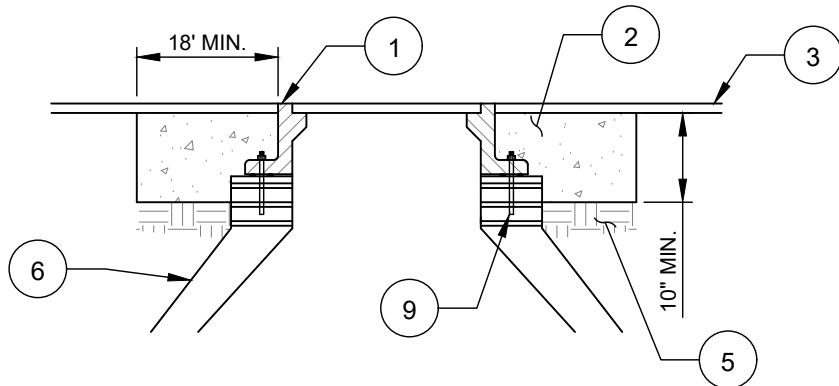
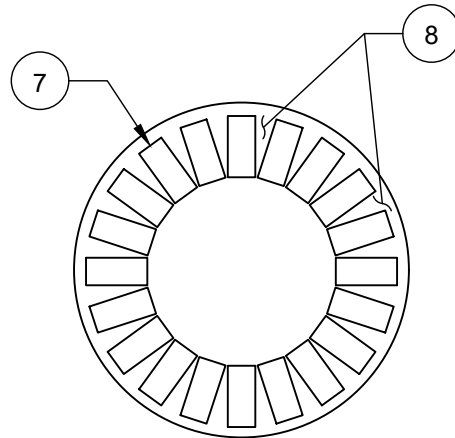

TYPICAL MANHOLE

NO. DESCRIPTION:

1. CLTW STANDARD FRAME AND COVER.
2. CONCRETE - 3,600 PSI.
3. NEW ASPHALT OVERLAY.
4. OLD PAVEMENT.
5. COMPACTED SUBGRADE.
6. MANHOLE CONE.
7. USE MIN. 1/2" BRICK PAVERS FOR ADJUSTMENT WITH 1/4" MORTAR JOINTS.
8. FILL ALL VOIDS SOLID WITH MORTAR.
9. 4 ANCHOR BOLTS ANCHOR FRAME TO SOLID BRICK, BLOCK OR CONCRETE. SET FRAME ON 2 RINGS OF BUTYL RUBBER MASTIC ROPE.

NOTES:

- A. FOR TYPICAL MANHOLES, REMOVE AND REPLACE ANCHOR NUTS AND WASHERS. REMOVE OLD BUTYL RUBBER MASTIC AS APPROVED.
- B. MANHOLE ADJUSTMENTS WILL BE COMPLETED AT LEAST 36 HOURS BEFORE RESURFACING.
- C. 18" MINIMUM WIDTH OF EXCAVATION AROUND MANHOLE.
- D. DISTURBED AREAS AROUND STRUCTURE ADJUSTMENTS ARE TO BE TAMPED AND FILLED WITH 3,600 PSI "HIGH EARLY" PORTLAND CEMENT CONCRETE.
- E. MORTAR USED TO ADJUST STRUCTURES IS TO COMPLY WITH THE N.C. DEPARTMENT OF TRANSPORTATION'S STANDARD SPECIFICATIONS FOR ROADS AND STRUCTURES.
- F. BRICK PAVERS USED TO ADJUST STRUCTURES MUST HAVE A MINIMUM THICKNESS OF 1/2 INCH AND A COMPRESSIVE STRENGTH OF AT LEAST 6,000 PSI.
- G. WOODEN WEDGES DRIVEN INSIDE THE BASE OF THE MANHOLE RING SHALL BE UTILIZED TO PREVENT THE STRUCTURE FROM SETTLING BEFORE CONCRETE AND MORTAR SET.
- H. THE BRICK PAVERS WILL BE LAID ON A FULL MORTAR BED SO THAT THE LONGEST DIMENSION OF THE BRICK WILL BE PERPENDICULAR TO THE MANHOLE STRUCTURE WALL. ALL VOIDS BETWEEN PAVERS SHALL BE FILLED WITH MORTAR.
- I. NO MORE THAN A 3/8 INCH JOINT WILL BE ALLOWED BETWEEN THE BRICK.
- J. ALL DAMAGED OR DETERIORATED STRUCTURE WALL ARE TO BE REPORTED TO THE INSPECTOR OTHERWISE CONTRACTOR ASSUMES RESPONSIBILITY FOR STRUCTURE FAILURE.
- K. IF THE SUM OF PREVIOUS ADJUSTMENTS PLUS THE NEW ONE ARE EQUAL OR GREATER THAN A STANDARD BRICK COURSE, OLD MORTAR AND SHIMS SHALL BE REMOVED DOWN TO THE PREVIOUS FULL BRICK COURSE AND A NEW STANDARD BRICK LAYER SHALL BE INSTALLED.
- L. ALL CONCRETE SHALL BE VIBRATED IN ACCORDANCE WITH N.C. DEPARTMENT OF TRANSPORTATION SPECIFICATIONS.
- M. CONCRETE ON MANHOLE TO BE POURED TO THE BOTTOM OF THE FIRST FULL COURSE OF BRICK OR 10" MINIMUM.