

4"-12" MAIN

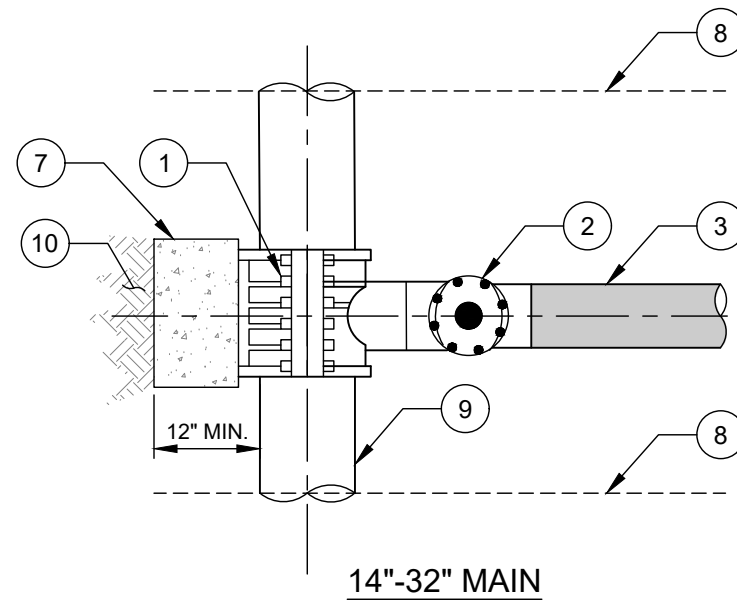

14"-32" MAIN

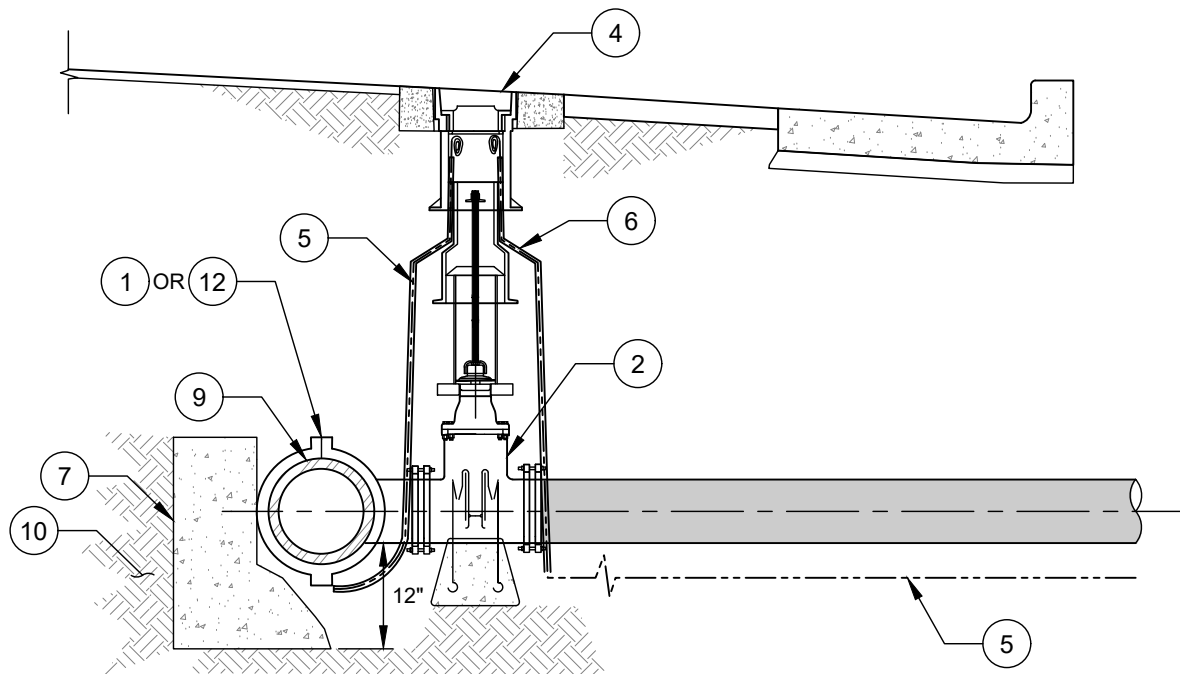

THRUST BLOCK TABLE	
TYPE OF FITTING	TEE OR DEAD END
TAP SIZE (INCHES)	TOTAL REQUIRED BEARING AREA (FT ²)
4	1.3
6	2.9
8	5.1
10	7.9
12	11.4
14	15.7
16	20.1
18	25.8
20	31.4
24	45.3
30	70.7
32	80.4

NO. DESCRIPTION:

1. ELECTROFUSION TAPPING SADDLE OR STAINLESS STEEL TAPPING SLEEVE WITH OUTLET SEAL GASKET.
2. FL X MJ TAPPING VALVE. REFER TO APPROPRIATE STANDARD DETAIL WITH CONCRETE SUPPORT.
3. HDPE PIPE.
4. STANDARD VALVE BOX ASSEMBLY.
5. AWG #12 GAUGE SOLID COPPER TRACER WIRE WITH BLUE 30 MILS HDPE INSULATION.
6. ALL VERTICAL WIRE SHALL BE PLACED IN 1/4" OR 3/8" ID CONDUIT SDR 9 PEX TUBING - ASTM F876 (TYP.).
7. CONCRETE THRUST BLOCK (SEE TABLE FOR SIZING).
8. TRENCH LIMITS.
9. EXISTING HDPE WATER MAIN.
10. UNDISTURBED NATIVE SOIL.
11. HDPE PIPE BUTT FUSION JOINT.
12. BUTT FUSED BRANCH SADDLE.

NOTES:

- A. BRANCH LARGER THAN THE EXISTING MAIN IS NOT ALLOWED.
- B. FOR EXISTING HDPE MAIN, USE ELECTROFUSION TAPPING SADDLE OR BUTT FUSED BRANCH SADDLE.

THRUST BLOCK NOTES:

- A. THRUST BLOCKS TO BE 3,600 PSI CONCRETE.
- B. THRUST BLOCKS TO BE POURED AGAINST UNDISTURBED SOIL.
- C. JOINTS TO BE KEPT FREE OF CONCRETE. ALLOW WORKING ROOM AROUND NUTS AND BOLTS. WRAP FITTING WITH 2 LAYERS HDPE FILM (HDCLPE PER AWWA C-105). EACH LAYER MINIMUM 4 MILS THICK.
- D. AREAS GIVEN ARE FOR DR 9 PIPE AT TEST PRESSURE OF 200 PSI IN SOIL WITH 2,000 PSI BEARING CAPACITY. CHANGES SUBJECT TO FIELD CONDITIONS AND APPROVAL OF THE SEALING ENGINEER.
- E. TAPPING SLEEVES SHALL HAVE THRUST BLOCKS SIZED BASED ON TAP SIZE.